

**Hebel**  
for future living

**PowerWall**

For external walls



DISTRIBUTORS FOR WESTERN AUSTRALIA

Make your dream home a **Hebelhome**



CSR Hebel Panel Wall Systems are an ideal alternative to brick veneer in timber or steel framed construction which provide substantial benefits to homeowners and builders. The heart of the system is Hebel PowerPanel™, a 75mm, corrosion protected steel reinforced panel which is installed vertically to steel top hat battens that are screwed to the frame.

Each panel is equivalent in area to around 72 bricks and can be installed in around 3 minutes. This makes the whole system quick to install and because Hebel PowerPanel is produced in industry standard lengths, there is very little wastage on site.

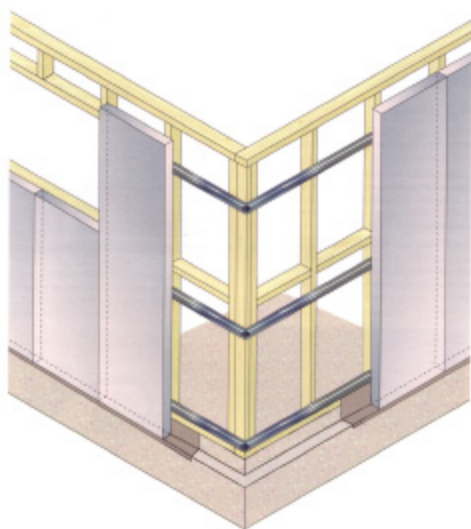

## Benefits

- **Design freedom** – create an individual design with a stylish rendered look
- **Solid feel** – reinforced AAC panels give a masonry feel
- **Quick to install** – considerably faster to install than brick veneer
- **Environmentally friendly** – low embodied energy/low wastage
- **Thermally efficient** – delivers additional comfort and energy savings